

# TANK LINERS

## How will a liner help

Our liners are a specially formulated high EVA non toxic polymer plastic which acts like a skin on the inside of the tank. Even if the tank moves due to expansion and contraction, the liner will remain flexible and watertight.

## Preparing the tank

It is important that the tank be ready for lining prior to unfolding the liner.

- 1) Is the tank clean and free of debris and sharp objects including rust or nails ?
- 2) The outlet and inlet pipes must protrude into the tank to allow the liner to fastened to ensure a watertight seal.
- 3) The outlet pipe can be plastic or metal, allow at least 100mm - 150mm to fix the liner inside the tank.

## Fitting the liner

No special tools are required to fit a liner.

The top (open edge) of the liner is sized to fit to the top edge of your tank. Do not attempt to remove what appears to be excess liner material as this has been calculated to the correct size for the measurements we have been given.

- 1) Inspect the tank and clean any debris from the tank. Cover or remove any sharp edges or nails in the walls or floor of the tank.
- 2) Unfold the liner inside the tank - do not snag the liner on any sharp objects, including tools.
- 3) Fix leading edge of open end of liner to the inside top of the tank. For concrete or wooden tanks, battens and nails can be used to fasten this edge. For iron tanks use pop rivets, bolts or adhesive to fix liner to clean iron walls.
- 4) Once top edge is fastened, ensure that all material is evenly distributed into corners and that liner is hanging straight with no gaps or voids between liner and tank walls.
- 5) The liner will be fastened to the inlet and outlet pipes using polythene tape as shown in the drawings below. We do not fit the liner with outlet or inlet tubes or fittings as this makes placement and positioning of the liner too critical during installation. Push and mould the liner around the outlet pipe so that the liner comes down the tank wall, around the pipe and back to the wall below the pipe. This can then be taped to the pipe as shown below. Specifications may vary from those stated in product information.

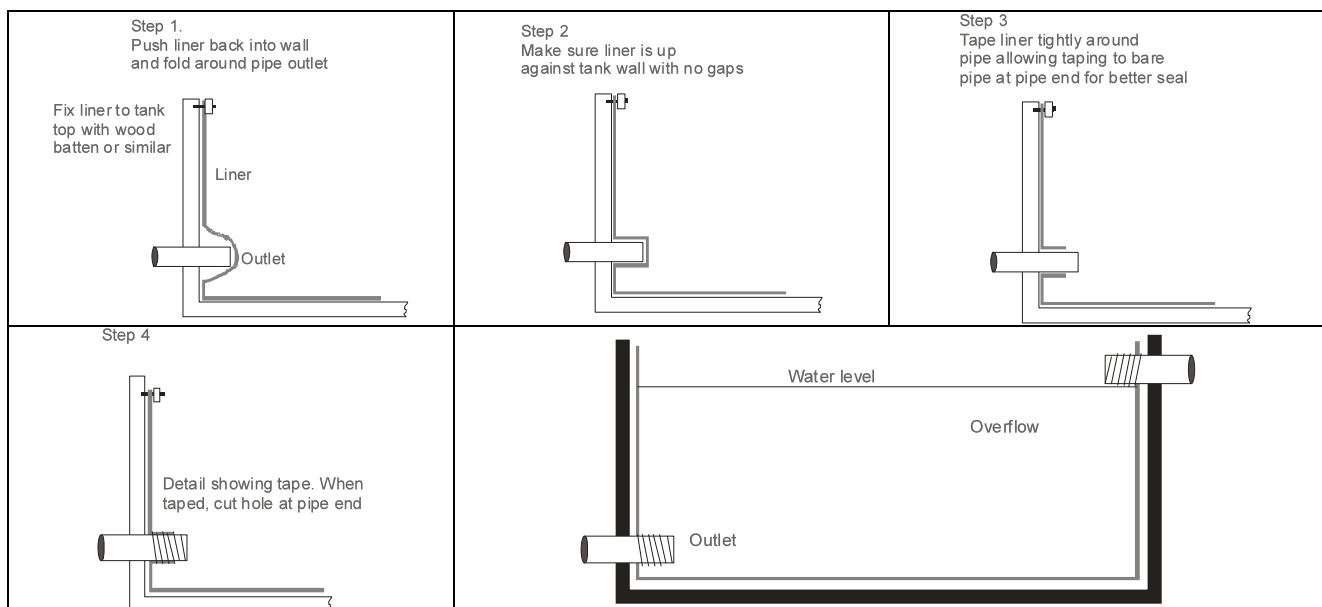

## Cosio Industries Ltd

P.O.Box 15014 New Lynn  
 27-33 Lansford Crescent Avondale, Auckland, New Zealand  
 Ph 09 820 0272 Fax 09 820 0274  
 Email : [sales@cosio.co.nz](mailto:sales@cosio.co.nz) Website : [www.cosio.co.nz](http://www.cosio.co.nz)